

DOWNTOWN COMMON PROJECT MAIN AVENUE PLAZA AND SPLASH PARK

May 2013

CURRENT FINANCIAL STATUS:

Original Project Cost	\$376,205.75
City Commitment- Bathrooms	(\$ 58,000.00)
Chobani Commitment	(\$ 50,000.00)
TFCF Fund (Inman/Bricks)	(\$ 38,444.64)
MagicFest Fund	(\$ 14,519.53)
Brick Sales to date- Rotary	(\$ 10,989.00)
Rotary Golf Tournament	(\$ 780.10)
Rotary Death by Chocolate	(\$ 13,888.00)
Rotary Danny Marona Show	(\$ 11,415.00)
Already paid to The Land Group	(\$ 39,835.20)
Balance to raise	<u>\$138,334.28</u>

OTHER:

Urban Renewal Commitment	(\$50,000.00)*
First Federal Foundation	(\$ 3,000.00)*
Seagraves Foundation	(\$10,000.00)*
Ice Cream Funday	(\$ 2,500.00)

Balance to raise \$ 72,834.28

*Verbal Approval but Final Written Commitment not received yet

MAIN AVE PLAZA & SPLASH PARK

ESTIMATED PROJ. \$ 380K

FUNDS
RAISED

CITY OF TF 58K

CHOBANI GRANT 50K

INMAN ESTATE 55K

SEAGRAVES FOUNDATION 7K

~~1ST FEDERAL BANK 3K~~

URBAN RENEWAL 50K

~~SEAGRAVES 50K~~

\$ 107K

GOLF & BRICK 5K

CURRENT GOAL \$ 102K

155K

• BRAINSTORM IDEAS / STRATEGIES

- 1.) GRANTS (TF FOUNDATION)
(DOWNTOWN COMMON)
- 2.) DANNY MARONA FUNDRAISER
- 3.) BUSINESS DONATIONS
 - DOWNTOWN BUSINESS
 - DOWNTOWN LARGE COMPANIES
- 4.)
- 5.)
- 6.)
- 7.)

HOW TO IMPLEMENT

- TIMETABLE
- MEASUREMENT
- WHO

→ EVENING EVENT / DINNER

MARCH - APRIL

- TABLE SALES → RECOGNITION
- BRICK SALES
- SILENT AUCTION
- DANNY MARONA
- EVENT COMMITTEE TO SELL
TICKET TABLES

4-6 MOS. FUNDRAISER
 DEMO - FALL
 SUMMER '13 COMPLETION

TWIN FALLS
 COMMUNITY FOUNDATION (2008) - TERRY MCCORDY
 (NOT A FUNDRAISER) A PROJ. MGR CHAIRMAN
 & NON-PROFIT FACILITATOR

Statement of Probable Cost

The Land Group, Inc.
 340 Falls Avenue, Twin Falls, Idaho 83301
 (208) 733-4041 Fax (208) 733-4045



AIA
 THE LAND GROUP, INC.
 SCOTT ALLEN

Job Title: TWIN FALLS FOUNTAIN PLAZA (T.F.C.F.)
 Project Number: 210009 (CITY'S #1 PROJECT)
 Date: 08/22/11

Description of Work/Materials	Units	Quantity	Price Per Unit	Total Amount
CIVIL CONSTRUCTION ITEMS				
Demolition	LS	1	12000.00	\$12,000.00
SWPPP	LS	1	2000.00	\$2,000.00
Rough grading	SF	11360	0.20	\$2,272.00
Adjust existing utilities	LS	1	1800.00	\$1,800.00
New asphalt patchback	SF	90	6.00	\$540.00
Electrical	LS	1	3500.00	\$3,500.00
Geotechnical investigation and report	LS	1	3000.00	\$3,000.00
Sewer service	LS	2	550.00	\$1,100.00
Water service	LS	2	675.00	\$1,350.00
Storm drainage	LS	1	2500.00	\$2,500.00
Lighting - light pole relocation w/new foundation	EA	3	700.00	\$2,100.00
Lighting - new light pole with foundation	EA	3	2500.00	\$7,500.00
CXT Ozark II Restroom & concrete pad	LS	1	58000.00	\$58,000.00
			SUBTOTAL	\$97,662.00
LANDSCAPE & HARDSCAPE ITEMS				
Bike racks	EA	2	500.00	\$1,000.00
Benches	EA	2	1500.00	\$3,000.00
Trash cans/recycling	EA	4	500.00	\$2,000.00
Wrought iron fence	LF	25	75.00	\$1,875.00
Tree grates	EA	4	2000.00	\$8,000.00
Stamped and colored concrete	SF	3825	12.00	\$45,900.00
Flatwork with scoring and steps	SF	5150	4.00	\$20,600.00
Central paving decorative pattern/symbol	LS	1	2000.00	\$2,000.00
Concrete pavers	SF	650	12.00	\$7,800.00
6" concrete edging	LF	120	2.00	\$240.00
Concrete seats & stone caps at shade structure	LF	186	120.00	\$22,320.00
Planter/Seat walls and wall caps	LF	232	100.00	\$23,200.00
Waterproofing of building walls at planters	LF	200	50.00	\$10,000.00
Sail cloth shade structure by Parasol and installation	LS	1	28500.00	\$28,500.00
Splash pad-fresh water w/controls & spray heads	LS	1	50000.00	\$50,000.00
Fine grade landscape	SF	1735	0.15	\$260.25
Planter beds - shrubs, soil amendments etc	SF	1735	4.00	\$6,940.00
Trees	EA	12	400.00	\$4,800.00
Mulch	SF	1735	0.50	\$867.50
Irrigation	SF	1735	0.60	\$1,041.00
			SUBTOTAL	\$240,343.75
TOTAL CONSTRUCTION COST				\$338,005.75
Construction surveying fee	LS	1	3700.00	\$3,700.00
Preparation of construction documents & spec's.	LS	1	34500.00	\$34,500.00
TOTAL PROJECT COST				\$376,205.75

Base Note: This Statement of Probable Cost is based on a limited understanding of the full scope of the project. It is recognized that neither The Land Group nor the client has any control over the cost of labor, materials or equipment, over the Contractor's methods of determining bid prices or other competitive bidding market forces. Bid prices will vary from any statement of probable construction cost or other estimate or evaluation prepared by The Land Group. For each year until the project is constructed, the construction costs must be adjusted for inflation based on the Construction Cost Index.

* #1500 BRICK FUNDRAISER? COST #1800K (TERRY)
 CITY - \$58,000 BATHROOMS
 VRA - \$50,000
 CHOBAN I \$50,000
 MARY INMAN - \$56,780
 Δ = \$161,000 TO RAISE

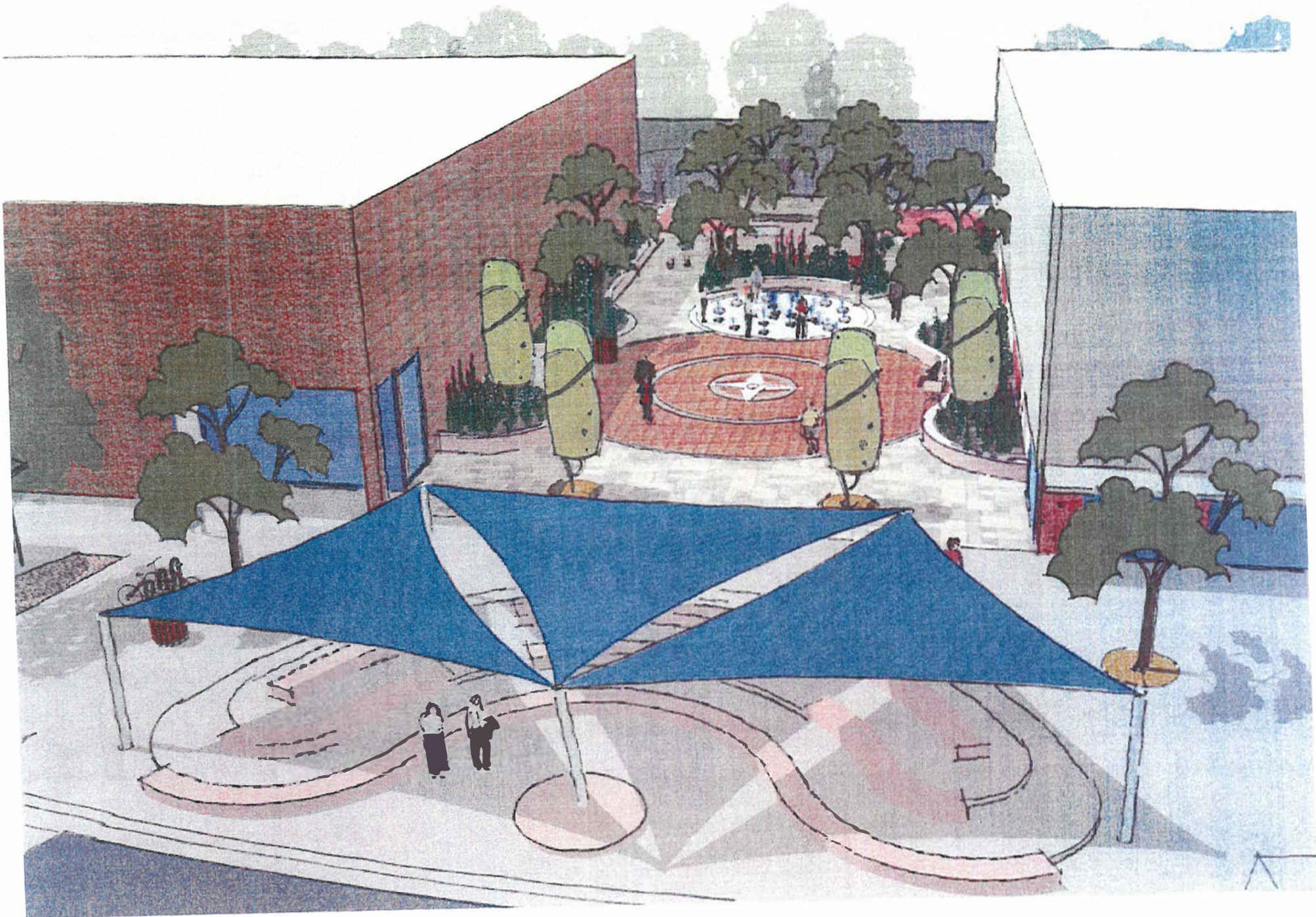

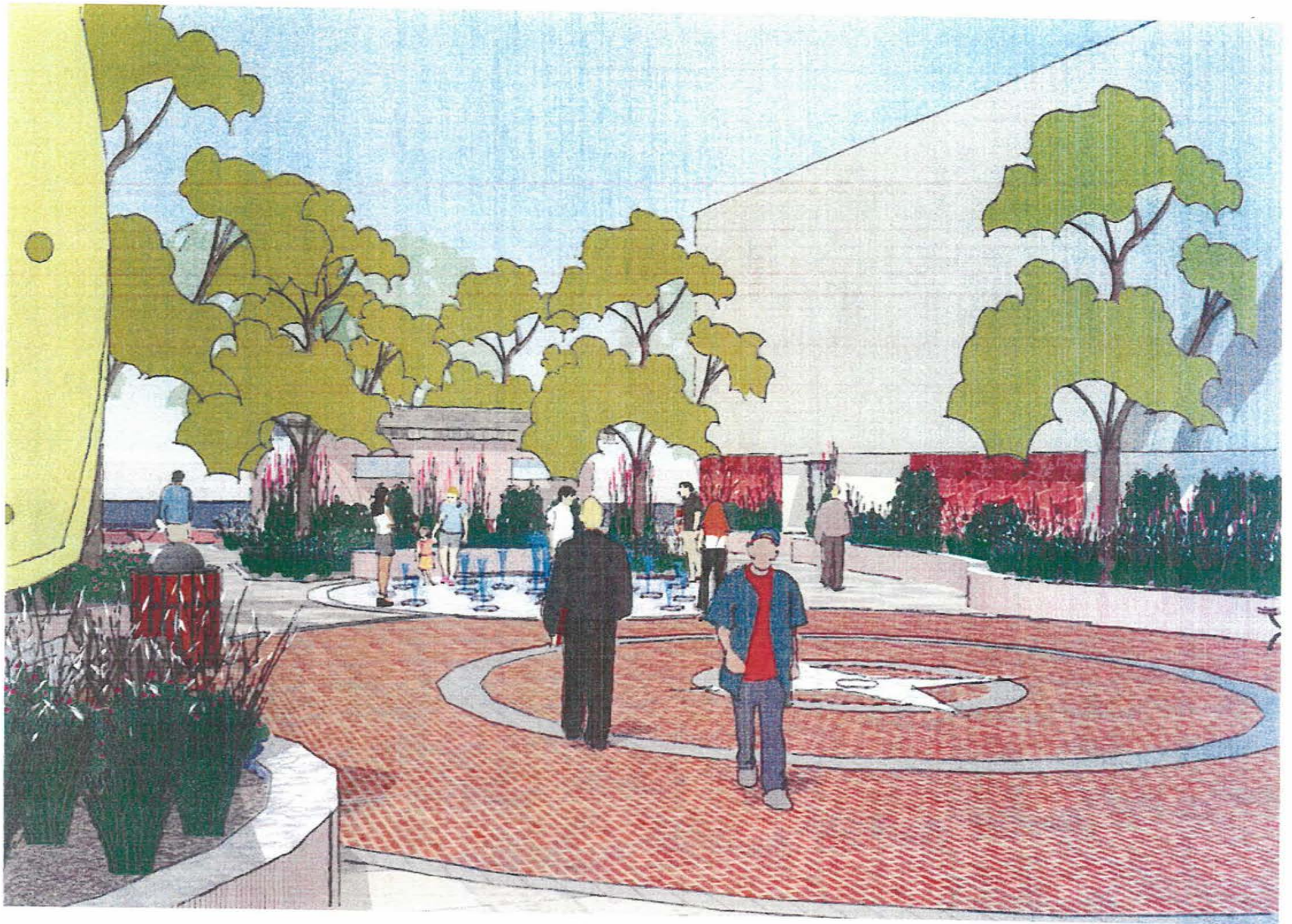



Times-News

magicvalley.com

P.O. Box 548, 132 Fairfield St. West, Twin Falls, ID 83303-0548
(208) 733-0931 ph (208) 734-5538 fax

September 20, 2012

Fellow Community Members,

This year we will be publishing a "**Community of Giving**" special section on **Thursday December 6, 2012**, and I'd like to invite you to participate.

This very special edition of the Times-News features a review of local non-profits and their philanthropic efforts along with overviews of how the efforts of thousands of volunteers fuel their programs, large and small.

Advertising in our "**Community of Giving**" section is an excellent way to promote your organization's charitable programs at this special year-end giving time, and expand your potential donor base at the same time, as the section is delivered to more than 20,000 households.

We have a special offer for non-profit organizations and charitable foundations: purchase a quarter, half or full page message, and the Times-News will double that space to give your organization the opportunity to tell your story, recognize volunteers or staff, or ask for that all important year-end contribution.

Please put this important outreach opportunity on your calendar. Our final space and copy deadline is in November, but I encourage you to call me at 208-735-3276 or email me at tammy.parker@lee.net early to reserve your space.

Thank you,

Tammy Parker
Sales Consultant
208-735-3276
tammy.parker@lee.net



TWIN FALLS ROTARY

Main Avenue Plaza Splash Fountain Fundraiser



**ENGRAVED
BRICKS**

4x8 Brick

1 for \$100

3 for \$250



www.twinfallsrotary.org



1-800-MOREFUN

Rotary Major Donor Prospecting "Report"

David Foster <dfoster@cableone.net>

Wed, Mar 20, 2013 at 3:12 PM

To: Paul Arrington <pla@idahowaters.com>, Terry McCurdy <terry@mvbs.net>, Danny Marona <dmcprod@aol.com>

Gentlemen:

Here are the results of my first efforts approaching our "assigned" list of Major Donor prospects:

Downtown Commons Major Donors Prospect Results 3-20-13



Project	Status		
US Bank	Next Week	Lawrence Flournoy ?	737-5000
Wells Fargo Bank	Binder Sent to Reg Ofc	Dave Dickerson	735-3536 ✓
Glanbia Foods	Binder Delivered and Online Grant Request Completed	Peggy Watlin and Janna Little <i>EMILY?</i>	733-7555 LM 4/9 RE: SHW ✓
Rob Green Auto Group	Binder Delivered and will be presented at next week's co. mtg.	Ricky Franks	733-1825 LM 4/9 RE: SHW ✓
Intermountain Gas	Next Week		737-6300
Con Agra Foods	Emailed presentation	Ruby Thomas <i>LM 4-9</i>	733-5664 Ext. 61301 ✓
Middlekauf Auto Group	Binder Delivered. Greg out of town until next week	<i>TIFFANY</i> Gregg Middlekauf <i>LM 4-9</i> <i>DALE GUPTON</i>	736-2480 ✓
Solo Cup (Dart Corp.)	Binder Delivered and Dart Foundation Online Grant Request in Process		733-7613 ✓
Farmer's National Bank	Delivered Binder	John Gibson <i>LM 4-9</i>	<i>WIC 4/16</i> 734-1017 ✓
Dick's Pharmacy	Delivered Binder	"Dan" <i>NO THANKS!</i>	734-7373 ✓
Starr Corporation	Emailed presentation	Michael Arrington (any relation to Paul?)	733-5695 ✓

I will keep you posted on further progress next week as I will be out of town until early next week.

Dave

High Street Band Performance Contract

This Contract, entered into on February 26, 2013 is for the personal services of the Musician(s) for the performance described below. The undersigned buyer and the undersigned artists agree and contract as follows:

1. ARTIST: High Street Band
2. BUYER: ~~LARRY LINEBERRY~~ TWIN FALLS ROTARY CLUB 
3. PERFORMANCE NAME/ADDRESS: Cactus Pete's Casino
4. DATE OF PERFORMANCE: April 13, 2013
5. TIME OF PERFORMANCE: TBD
6. LOAD IN/SOUND CHECK: TBD
7. GUARANTEED WAGE AGREED UPON: \$3000.00
8. DEPOSIT: \$1000.00
9. ADDITIONAL TERMS:
 - A. BUYER TO SEND DEPOSIT CHECK TO:
 - I. HIGH STREET 2812 GREENVALE PL. NAMPA, ID 83686
 - ~~B. BUYER TO PROVIDE 7 HOTEL ROOMS AND MEAL VOUCHERS.~~ 
10. This contract constitutes a complete and binding agreement between the Buyer and the musician(s).
11. In case of cancellation of this contract by Buyer, if within 6 months of performance date the Buyer agrees to pay half the amount stated in Section 7. If the cancellation occurs within 30 days of performance the Buyer agrees to pay total amount stated in Section 7.
12. Neither the Performer nor the Buyer will be held liable for any failure to perform its obligations under this Agreement where such breach is due to any of the following: acts or regulations of public authorities, labor difficulties or strike, inclement weather, epidemic, interruption or delay of transportation service, acts of God, or any other legitimate cause beyond the reasonable control of the Artist and the Buyer. However, failure to perform will result in the Artist returning any and all outstanding funds to the Buyer.

STEVE GOFF

208-880-5765



FOR ARTIST

FOR BUYER TWIN FALLS ROTARY CLUB



[Back to Corporate Giving](#)

Wells Fargo Grant Application

[Edit Profile](#) | [Logout](#)

Welcome, Paul Arrington!

Welcome, Paul Arrington!

The organization you are currently associated with is **Rotary Club of Twin Falls Foundation**.

If you work with multiple organizations and want to submit an application for an organization different from the above, please [add a new organization to your account](#).

Application Overview

The Wells Fargo Grant Application consists of the following **five** sections. Each section must be completed in order to submit your proposal.

- Contact Information
- Organization Information
- Project Details
- Demographics
- Community Development Support

Once submitted, your application cannot be modified, so you may wish to [familiarize yourself with a READ-ONLY version of the online application](#) before beginning.

READY TO BEGIN? Click the "Start a New Application" link at the end of these instructions.

Helpful Hints

Before you begin, we recommend that you review the following:

- **To save an in-progress application and return to work on it later:** Close your browser after clicking the "Save and Proceed" button.
- **To return to your saved application:** Type the following URL in your browser's address bar to gain access the login screen directly:

www.cybergrants.com/wellsfargo/communitygrants

You may wish to bookmark this link for future reference.

Once you've logged in again, click the "Continue" link to the left of the application's Project Title, below.

• **To delete an incomplete or erroneous application that you've started:** Click the trash can icon next to its Project Title, below.

• **To print a paper copy of your completed application:** Prior to submitting your application you will see a summary screen of your entire application. Select "Print" from your web browser's "File" menu.

• **To review an application that your organization has previously submitted:** Click the "View" link next to the appropriate Project Title below.

NEED HELP? If you have technical questions regarding this application, use the "Need Support" link located at the bottom of every page to contact our support team.

Navigation

Each section of the application will have a timeline like the one below to help you monitor your progress. The arrows (>>) indicate your current position. Clicking a link in the timeline will take you to that section.

[Welcome Page](#)

[Contact Information](#)

[Organization Information](#)

[Proposal Information](#)

[Demographics](#)

[Community Development Support](#)

» Start a New Application «

[Need Support?](#)

OTHER FUNDING SOURCES

Please document the status of other sources of funds being pursued in support of the project/program.

Source	Amount	Status
Identify the name of the entity and classify as government (G), foundation (F), corporate (C), individual (I), special events (S), or other (O).	Please indicate the amount requested or, if approved, the amount to be funded.	Indicate whether the funding request is pending (P), declined (D), or approved (A).
1) City of Twin Falls (G)	\$ 58,000.00	(A)
2) Chobani Foods (C)	\$ 50,000.00	(P)
3) Mary Inman Fund (F)	\$ 56,780.00	(A)
4) MagicFest Fund (O)	\$ 17,394.53	(A)
5) Twin Falls Rotary Club - Brick Sales (F)	\$ 8,200.00	(A)
6) Twin Falls Rotary Club - Golf Tournament (F)	\$ 780.10	(A)
7) Twin Falls Rotary Club - Death By Chocolate (F)	\$ 13,888.00	(A)
8) Twin Falls Rotary Club - Ice Cream Funday (F)	\$ 2,350.22	(A)
9) Twin Falls Rotary Club – Danny Marona Farewell Show (F)	\$ 20,000.00	(P)
10) Twin Falls Community Foundation – Brick Sales (F)	\$ 1,650.00	(A)
11) Glanbia Foods (C)	\$ 10,000.00	(P)
12) Dick’s Pharmacy (C)	\$ 2,500.00	(P)
13) Combined Thirteen (13) Other Local Businesses (C) @ \$10,000 ea.	\$ 130,000.00	(P)

501c3

ROTARY →

- KRIS ANNE
- BRANDON

Hi Terry, Dave, Paul and Danny:

Here is a breakdown of two packages for the proposed April 13 date that we feel would go over well with this show. We have created a ticket only price and two packages deals. Basically, we are going to give your charity a percentage of each package that is sold. So, we would encourage you to not only sell tickets for the show, but also try and focus on the package deals, which will result in additional funds for your charity. Historically, Danny's ticket prices have been \$15, \$20 and \$25. However, since this is for a charitable event, we think this price could be increased. We will leave the pricing decision to you and your team and you can let us know what you feel is the best.

The maximum for ticket sales for this event for the Gala Showroom would be 290 Guests. Ticket prices are based on where the Guests books their seats in the Gala Showroom. Click on this link and you will be able to see the pricing structure.

http://www.ameristar.com/Files/CP_Gala_Seating_2009.pdf

Additionally, we would set up a cash bar for Guests to utilize before and during the show. Sales from the cash bar will be retained by Cactus Petes to cover the cost of staffing for the event.

Please let us know what your thoughts are on these packages. We will both be in the office on Tuesday, January 15 if you have any follow up questions or would like to discuss further.

Tickets Only \$30 each - this is an estimate, as we are not sure what you were thinking for ticket prices.

Package 1

Ticket Price \$60
Room Price \$129 (Current Tower Room Rack Rate)
Total Value \$189
Package Price \$149 – a 21% discount

Your charity will receive \$100 from each Package 1 that is booked

Package 2

Ticket Price \$60
Room Price \$129 (Current Tower Room Rack Rate)
Buffet \$46 (or we could make this a generic food comp at \$50)
Total Value \$235
Package Price \$179 – a 24% discount

Your charity will receive \$110 from each Package 2 that is booked

We look forward to hearing from you,

Brandon Smith

Director of Player Development
Ameristar Casinos - *Cactus Petes & Horseshu*
Jackpot, NV

775 755 6700 - office
208 316 3272 - cell

www.ameristar.com

Media Contacts

Roxann Kinkade, APR
Director of Communications
Ameristar Casinos, Inc.
816-414-7007
roxann.kinkade@ameristar.com

Kris Ann Brown
Public Relations Manager
Cactus Petes Resort Casino
775-755-6073
krisann.brown@ameristar.com

About Ameristar

Ameristar Casinos is an innovative casino gaming company featuring the newest and most popular slot machines. Our 7,200 dedicated team members pride themselves on delivering consistently friendly and appreciative service to our guests. We continuously strive to increase the loyalty of our guests through the quality of our slot machines, table games, hotel, dining and other leisure offerings. Our eight casino hotel properties primarily serve guests from Colorado, Idaho, Illinois, Indiana, Iowa, Kansas, Louisiana, Mississippi, Missouri, Nebraska and Nevada. We began construction on our ninth property, a casino resort in Lake Charles, La., in July 2012, which we expect will open in the third quarter of 2014. We have been a public company since 1993, and our stock is traded on the Nasdaq Global Select Market. We generate more than \$1 billion in net revenues annually.

Visit Ameristar Casinos' website at <http://www.ameristar.com>